

Current availability
1,793–62,434 sq ft

EST. 1828

INTERNATIONAL HOUSE

ST. KATHARINE DOCKS

International House

Floor plan: Mezzanine

9,799 sq ft / 910 sq m



Indicative Only. Not to scale

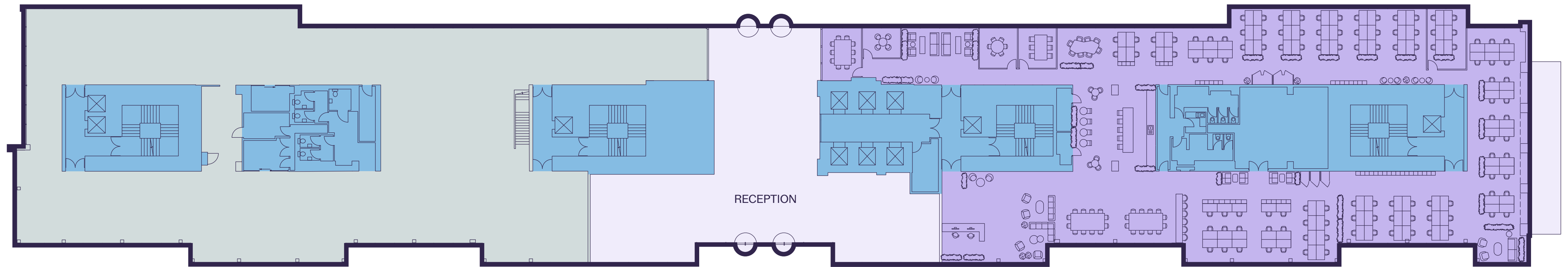

- Available unit
- Core/Lifts/WCs
- Existing tenant



International House

First floor

1,793 sq ft / 167 sq m



Indicative Only. Not to scale

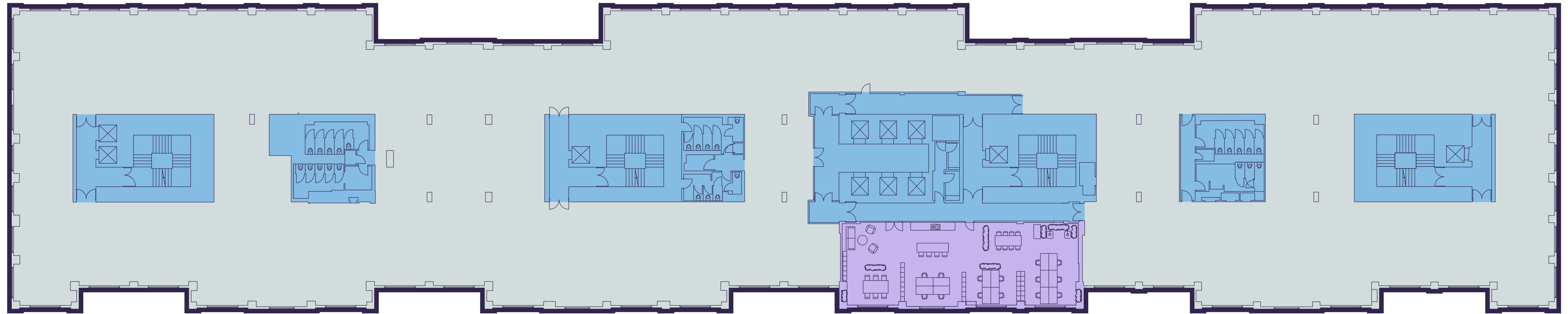

- Available unit
- Core/Lifts/WCs
- Existing tenant



International House

Third floor (South)

15,227 sq ft / 1,415 sq m



Indicative Only. Not to scale

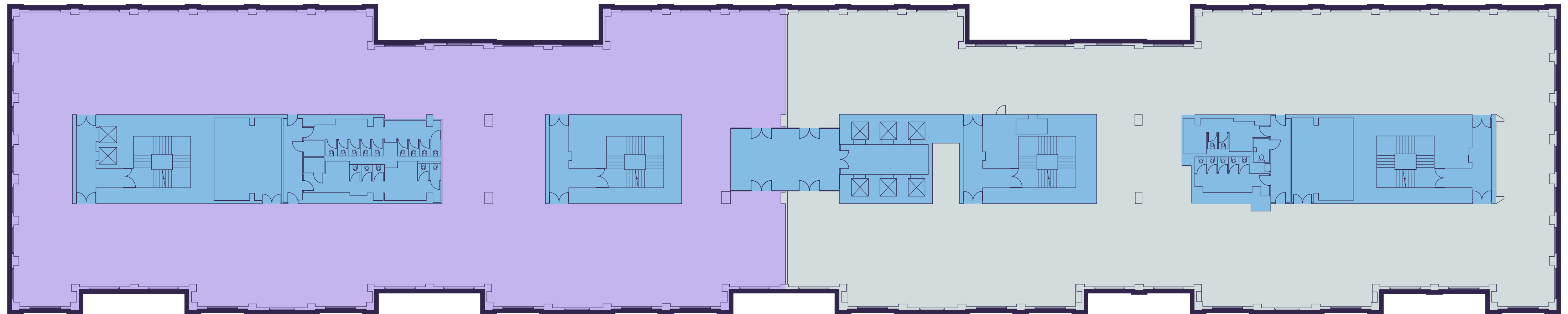

- Available unit
- Core/Lifts/WCs
- Existing tenant



International House

Fourth floor (North)

9,307 sq ft / 865 sq m

Fourth floor (South)

16,509 sq ft / 1,533 sq m



Indicative Only. Not to scale



- Available – North
- Available – South
- Core/Lifts/WCs
- Existing tenant

